

Masterlock 606

Bypass

This lock gets a lot of stick. It's a shed lock, really. And people who rob sheds don't carry covert entry tools.

You'll need the deep hook lock pick (marked Dangerfield Serenity). Place it with the hook facing the pins and the base of the pick along the base of the keyway. Push it all the way to the back, beyond the pins and into the actuator. Angle the back of the pick upwards, imagining the hook pivoting down in the back of the lock.

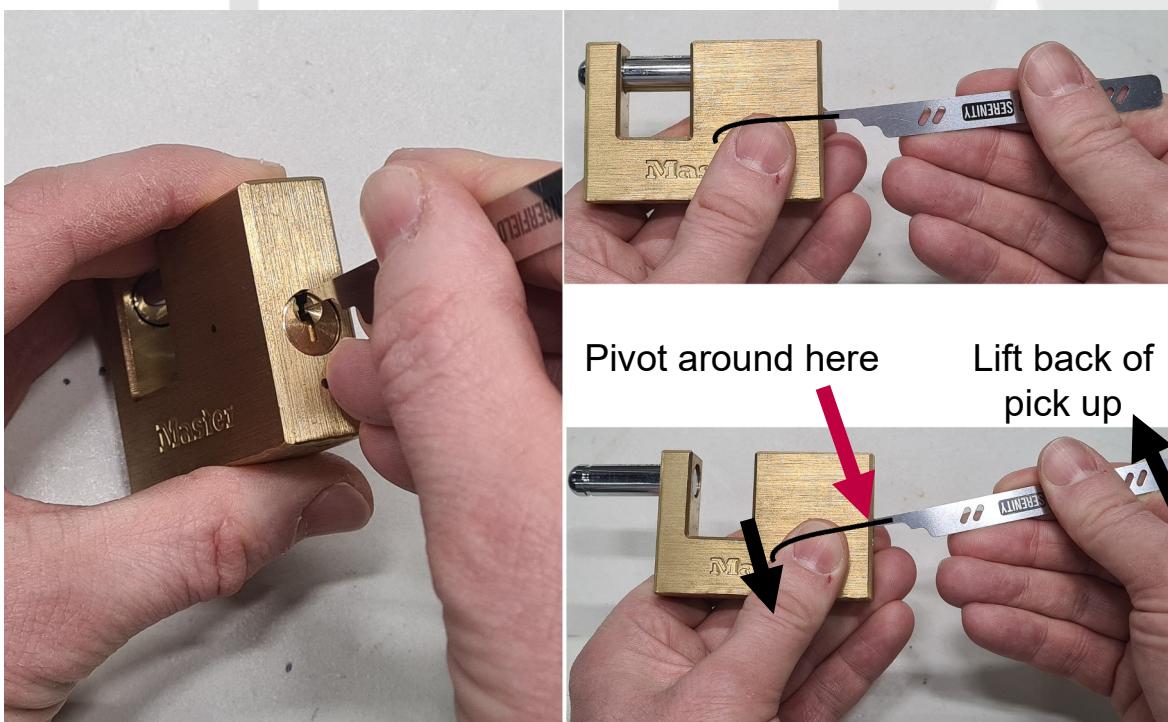

Imagine the tip moving downwards.

If you pay around fifteen quid for a lock, you probably don't get to complain that it isn't hardened against covert entry.

Enquiries@StyxSecurity.org

We don't knock.

Masterlock Excell M1 1/2

Rake

This is a lock.

I use one to hold up my washing line.

You are about to violate this lock. Strap in.

This is a very bad example of a very mediocre lock.

First insert the tension tool in the base of the keyway. It shouldn't catch on anything.



Now place the pick in as shown. The pick should run parallel to the warding (sticky out bit of keyway) you can see marked.

Push the pick in as far as it goes, no pressure on any tool.

When it's in, you can put "moderate" tension on the tension tool.



What is "moderate tension" you ask? I wish you hadn't as it's a pig to communicate tension. It's between these two:

Light – slightly more than resting your finger on the tool.

Heavy – this digs into your finger. It won't hurt, but you'll tire of it rapidly.

Remember: it's a rotational force you're applying.

Enquiries@StyxSecurity.org

We don't knock.

Masterlock Excell M1 2/2

Rake

You should now be holding the lock with one hand and have a finger pushing on the tension tool.

Pivot around the marked red arrow, pulling the back of the pick down, imagining the other end pivoting upwards in the lock.

You should hear a click and feel the tension tool move. Push it.

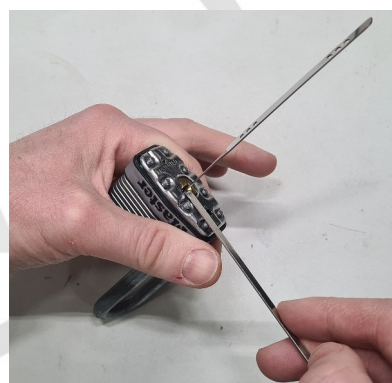
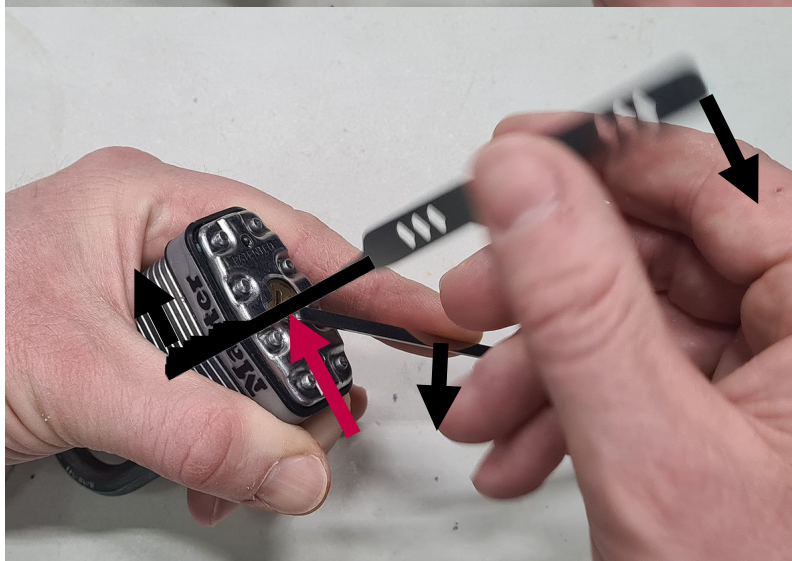

You can push the tension tool part of the way with your finger, but you'll need to use the hand that was on the pick to move it the rest of the way. The lock will pop open.



Enquiries@StyxSecurity.org

We don't knock.